



RAINMAX  
Rainwater Harvesting Filters



RAINMAX<sup>TM</sup>  
Rainwater Harvesting Filters

## WHY HARVEST RAINWATER?

Many of urban India's borewells have gone dry, and India may soon be classified as a drought zone as per recent surveys. An average Indian household spends more than Rs.12000 on water tankers annually. Rainwater Harvesting is the solution. For example, harvesting 1 season's rainfall in a city like Hyderabad (average annual rainfall of approximately 760 mm), can sustain the water needs of the city's entire population for 2 years. The other benefits include:

- Cleaner water with low hardness
- Cost savings – no more water tankers
- Recharging groundwater
- Prevention of urban flooding

+91-89191-59431  
info@rainmax.co.in  
www.rainmax.co.in

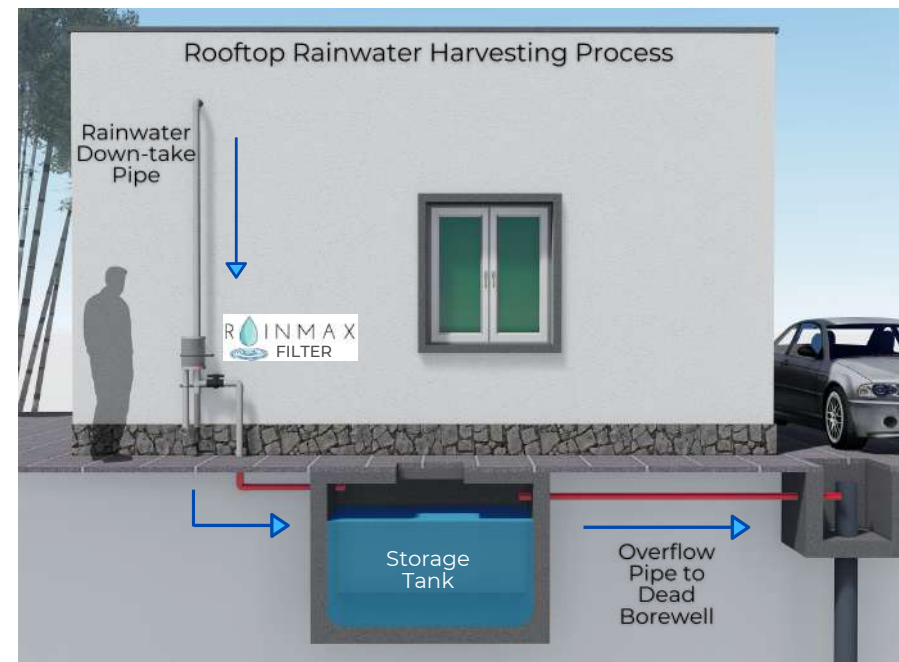

# HOW OUR FILTER WORKS

Rainwater from the rooftop passes through downtake pipes and enters the filter chamber. It filters through a fine 200-micron stainless steel (SS) 304 mesh. Around 5-10% of this water, along with leaves and debris, empties out through the waste water outlet. The remaining water enters into the first flush system, where initial turbid rainwater is trapped below the float ball and drained through the ball valve. Clean water then enters into the storage tank through the clean water outlet.

## FEATURES

- Two-stage filtration
- Self-cleaning
- 200 micron SS mesh
- First flush system

## ELIMINATES

- Dust
- Leaves
- Contaminants
- Other debris

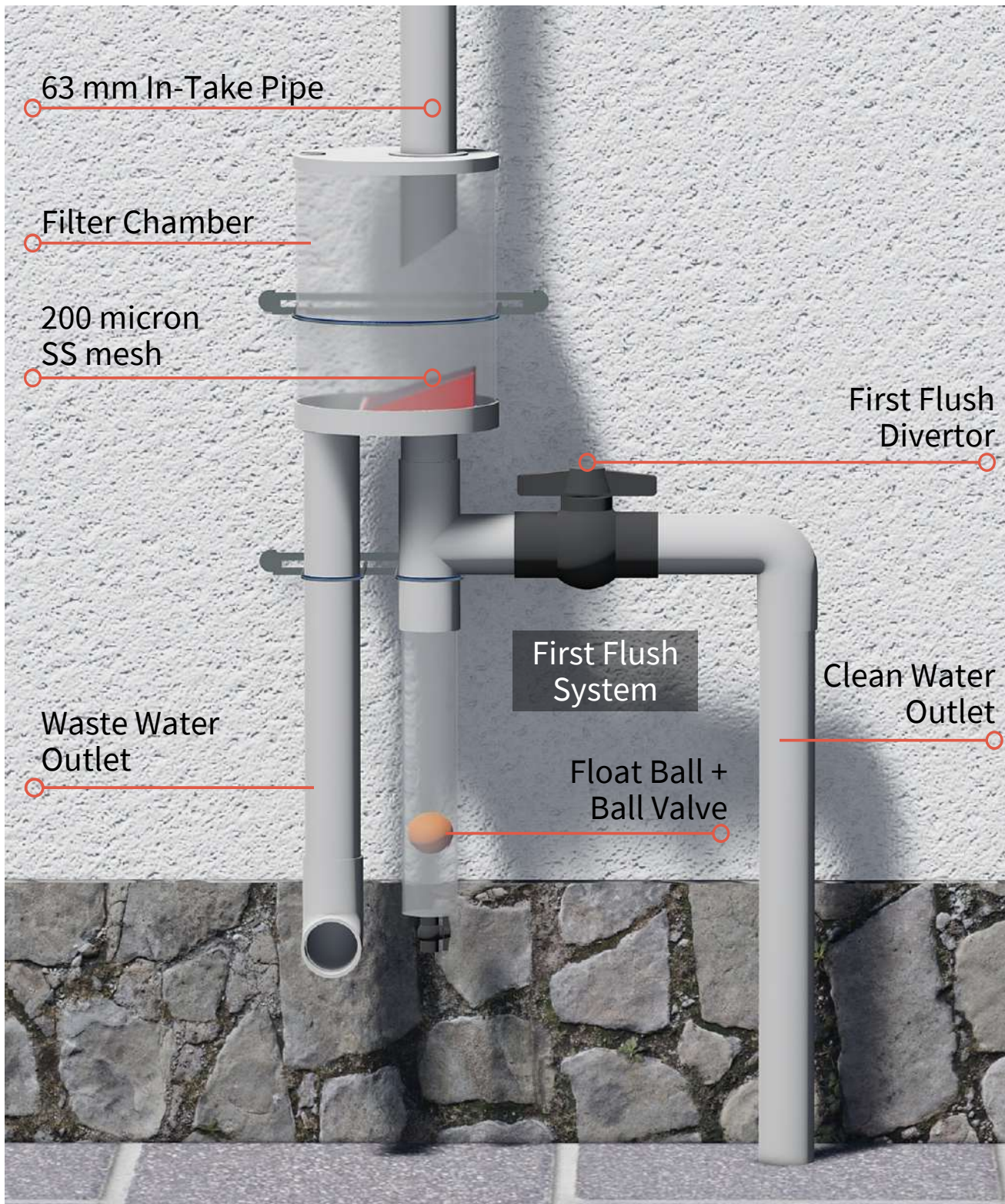

63 mm In-Take Pipe

Filter Chamber

200 micron  
SS mesh

First Flush  
Divertor

First Flush  
System

Waste Water  
Outlet

Clean Water  
Outlet

Float Ball +  
Ball Valve

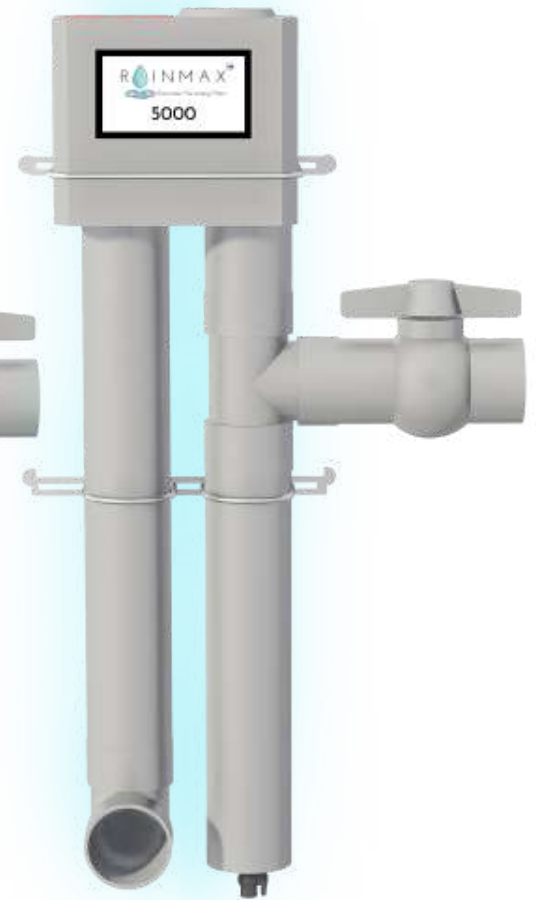
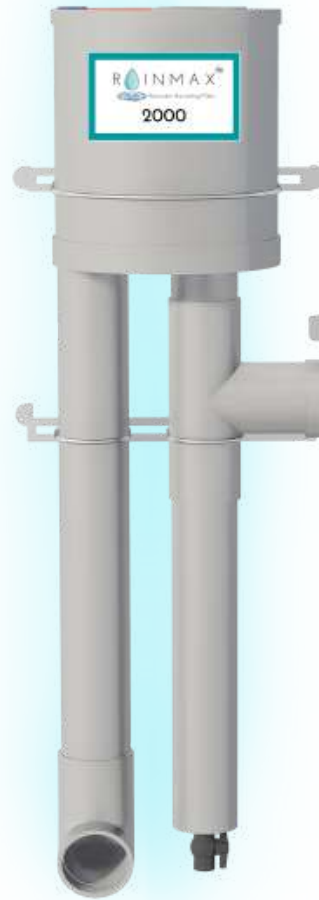

## RAINMAX *Simplex*

A smart, basic variant that comes without the First Flush System. Serves roof areas of up to 1000 sq.ft.

## RAINMAX 1000

Serves roof areas of up to 1000 sq.ft.

## RAINMAX 2000

Serves roof areas of up to 2000 sq.ft.

## RAINMAX 5000

Serves roof areas of up to 5000 sq.ft.

# SPECIFICATIONS

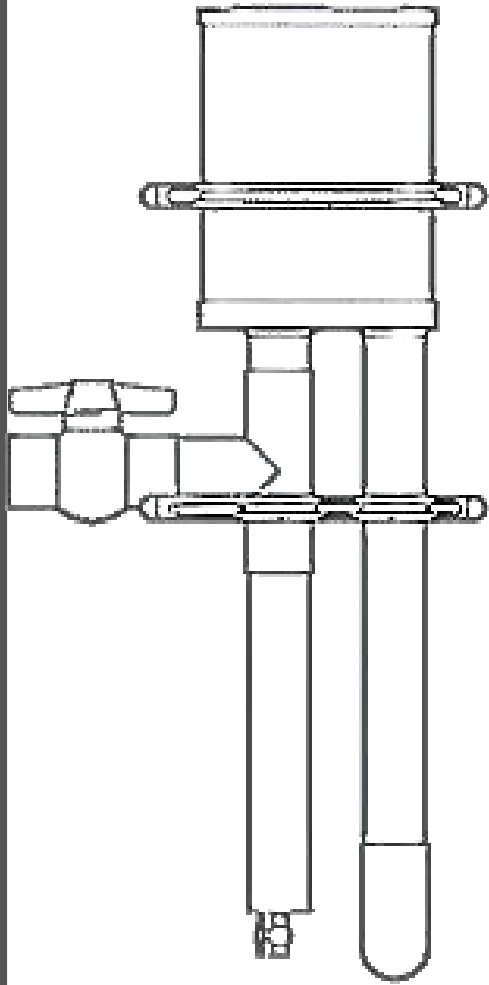

Serves Roof Area Up To
First Flush System
Working Principle
Filter Element
Mesh Size
Inlet
Clean Water Outlet
Waste Water Outlet
Filter Efficiency
Filter Body

RAINMAX <i>Simplex</i>	RAINMAX 1000	RAINMAX 2000	RAINMAX 5000
1000 sq. ft.	1000 sq. ft.	2000 sq. ft.	5000 sq. ft.
X	✓	✓	✓
Gravitational Force (Does Not Use Electricity)			
Stainless Steel (SS) 304 Mesh			
100 micron (for fine filtration)			
63 mm	63 mm	75 mm	110 mm
63 mm	63 mm	75 mm	110 mm
63 mm	63 mm	75 mm	110 mm
95%	95%	95%	95%
Polypropylene Copolymer (PPCP) & Polyvinyl chloride (PVC)			

# INSTALLATION

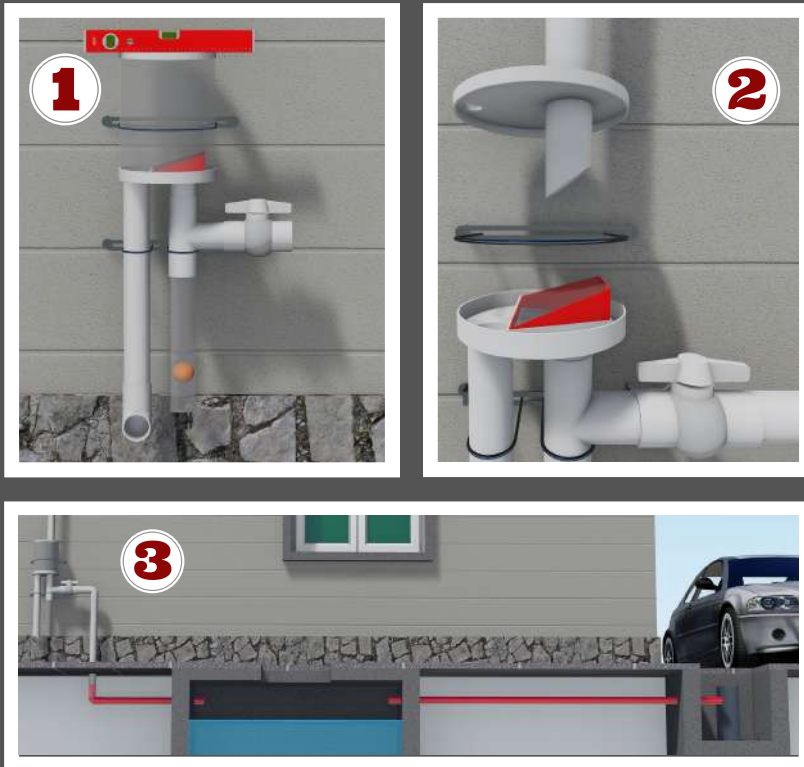

## STEP 1

Affix the filter on to the wall, using the U-bolts and brackets provided.

## STEP 2

Connect the rooftop pipe to the filter chamber.

## STEP 3

Connect the clean water outlet to the storage tank, and the overflow pipe to the borewell.

# MAINTENANCE

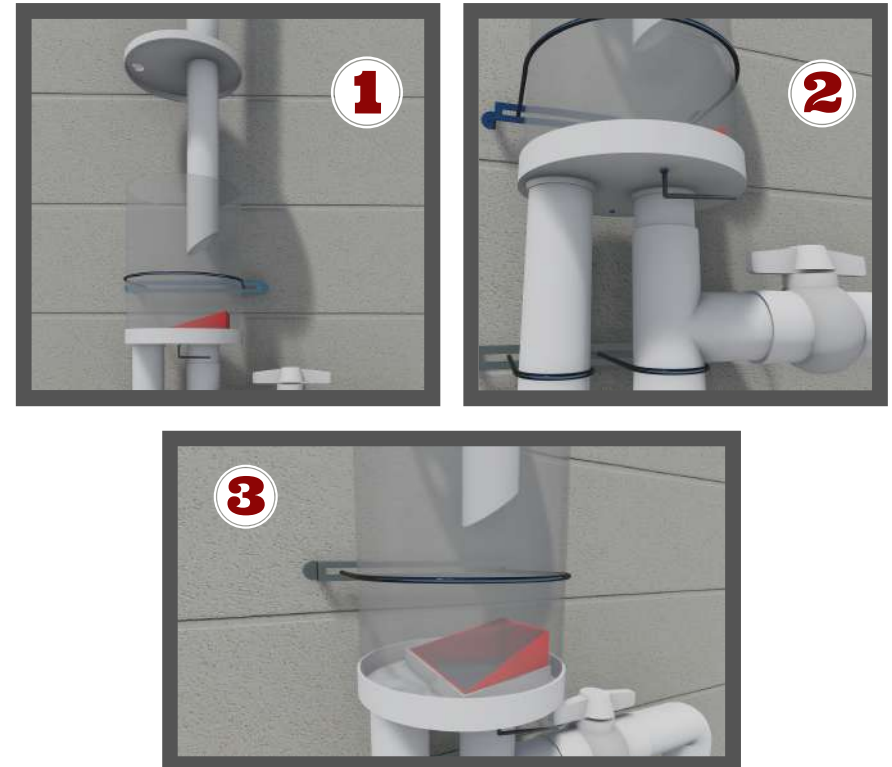

## STEP 1

The Rainmax filters are self cleaning.

We suggest this easy annual maintenance process to maximize efficiency.

Lift the cap off the top of the filter chamber.

## STEP 2

Loosen the bolts with the hex key provided.

## STEP 3

Clean the stainless steel filter mesh gently with a brush. Re-assemble.

# THE INJECTION WELL SYSTEM

The Alternative: The Rainmax Injection Well System is the most beneficial and cost-effective technique for gated communities & apartment building to ensure constant supply of groundwater without depending on water tankers. This system has the ability to recharge groundwater with 80,000 - 1,00,000 litres of water per hour. This means that 1 season of average rainfall will provide 8,00,000 - 10,00,000 litres of water for domestic needs of an apartment building of 50 flats (10,000 sq. ft. rooftop area). Please do not hesitate to reach out to us for more information,

## BENEFITS

- Recharges Groundwater
- Improves Groundwater Quality
- Highest output per sq. ft. area

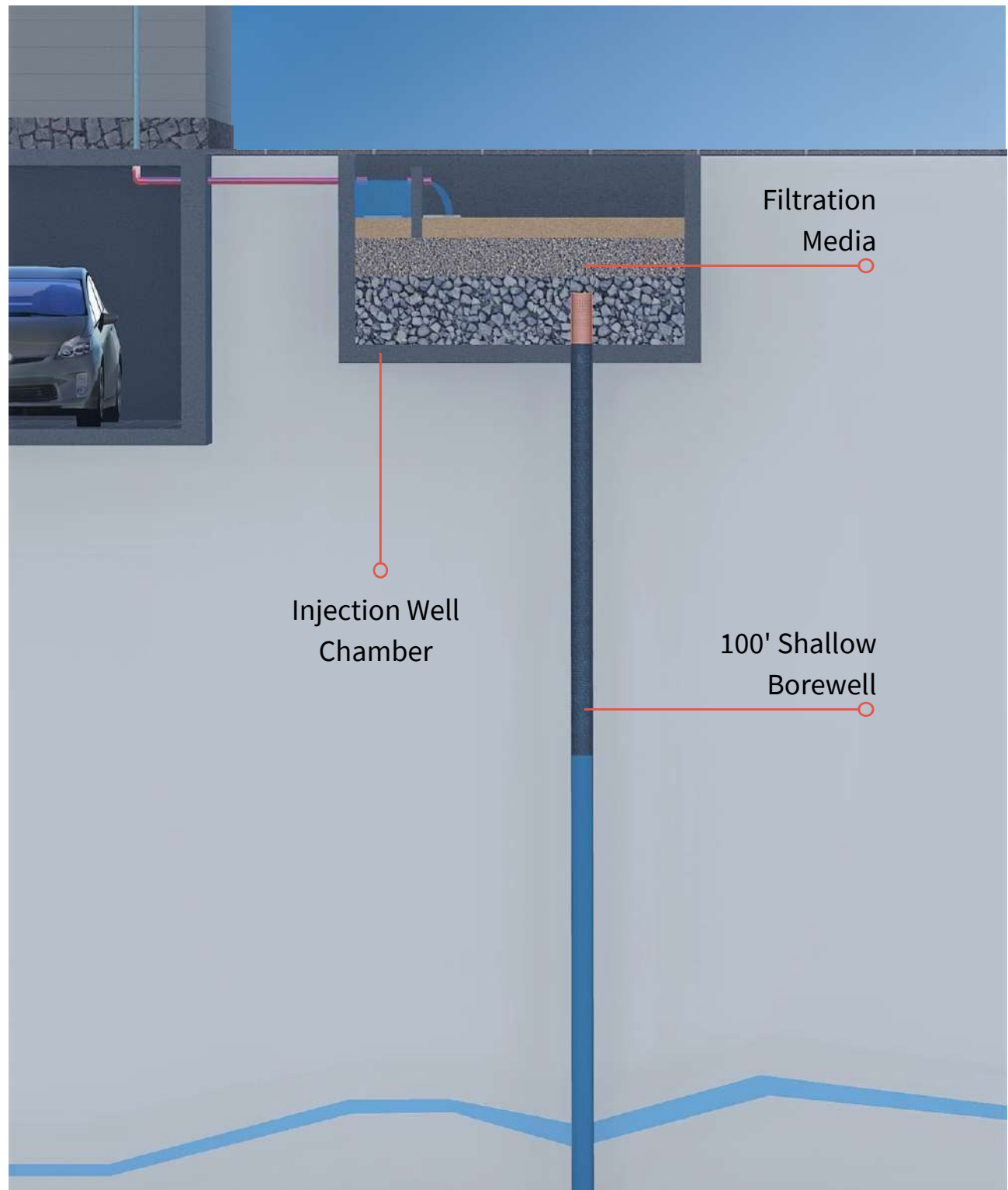



(091) 89191 59431



info@rainmax.co.in



[www.rainmax.co.in](http://www.rainmax.co.in)

